



SSCS4148AS6/SSCS4148CAS6 SSCS4148CCS6/SSCS4148SES6

SSCS4148AS6 /SSCS4148CAS6 SSCS4148CCS6/SSCS4148SES6

Fast Switching Diode

● Features

- ✧ Fast Switching Speed
- ✧ Ultra-Small Surface Mount Package
- ✧ Low Reverse Leakage Current
- ✧ Ideal for Battery Powered Portable Applications
- ✧ RoHS Compliant/Green EMC
- ✧ Moisture Sensitivity: Level 3 per J-STD-020

● PIN configuration

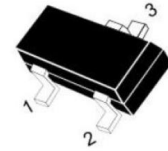

SOT-23

✧ Applications

- ✧ High speed switching for detection
- ✧ Battery Powered Portable
- ✧ Mobile phones, laptops and other electronic devices

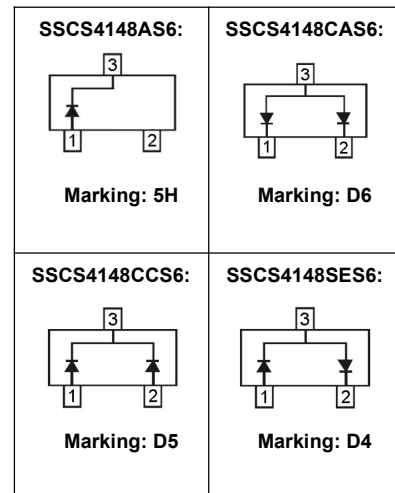

Circuit Diagram

● Absolute maximum rating @T_A=25°C

| Parameter | Symbol | Value | Unit |
|---|------------------|------------|------|
| Continuous Reverse Voltage | V _R | 75 | V |
| Peak Repetitive Reverse Voltage | V _{RM} | 100 | V |
| Average Rectified Forward Current | I _O | 200 | mA |
| Non-repetitive Peak Forward Surge Current @ t=8.3ms | I _{FSM} | 2.0 | A |
| Power Dissipation | P _D | 350 | mW |
| Thermal Resistance from Junction to Ambient | R _{θJA} | 357 | °C/W |
| Junction Temperature | T _J | 150 | °C |
| Storage Temperature | T _{STG} | -55 ~ +150 | °C |



● **Electrical Characteristics @T_A=25°C**

| Parameter | Symbol | Conditions | Min. | Typ. | Max. | Unit |
|-------------------------------|-----------------|--|------|------|------|------|
| Reverse Voltage | V _{BR} | I _R = 100uA | 75 | | | V |
| Reverse Current | I _R | V _R = 75V | | | 5.0 | μA |
| | | V _R = 25V | | | 25 | μA |
| Forward Voltage | V _F | I _F =10mA | | | 1.0 | V |
| Capacitance between terminals | C _T | V _R = 0V, f = 1MHz | | | 4 | pF |
| Reverse recovery time | t _{rr} | I _F =I _R =10mA, R _L =100Ω, I _{rr} =0.1I _R | | | 4 | ns |

● **Typical Performance Characteristics**

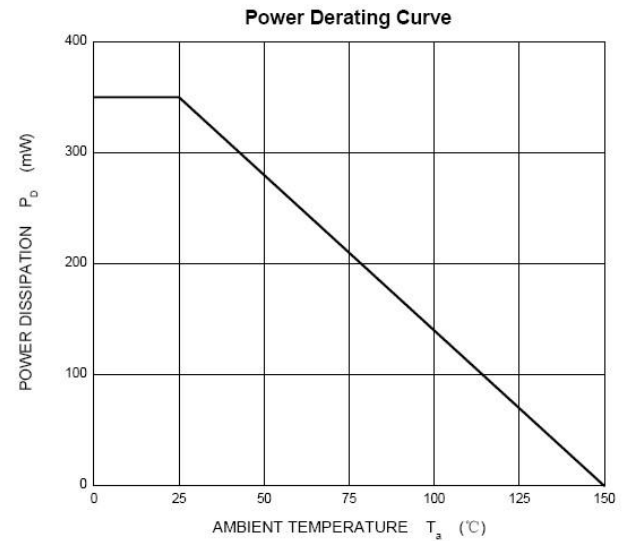
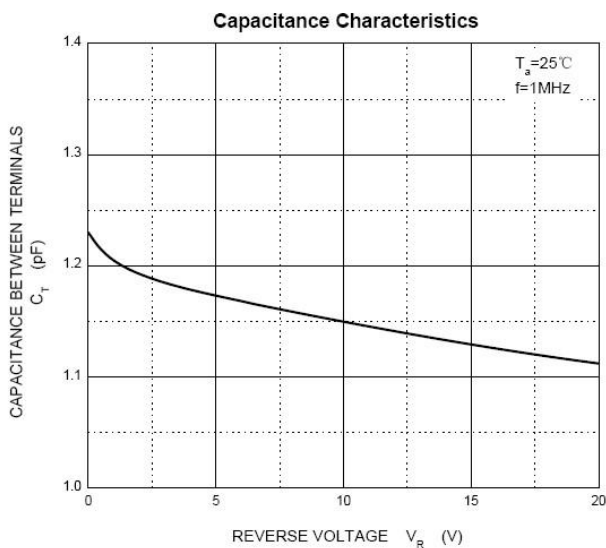
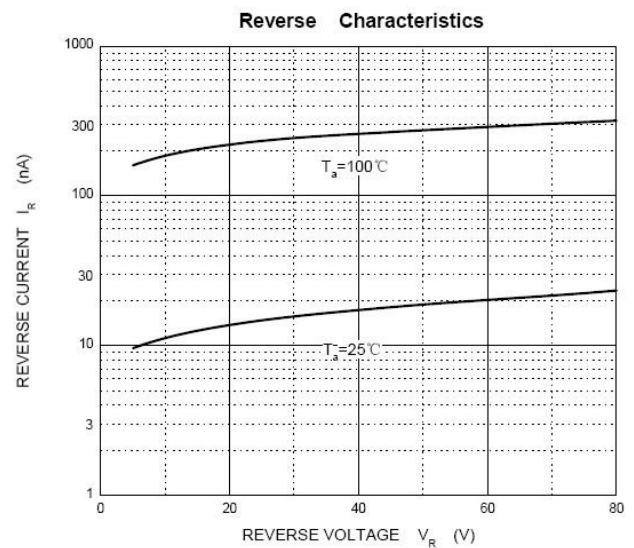
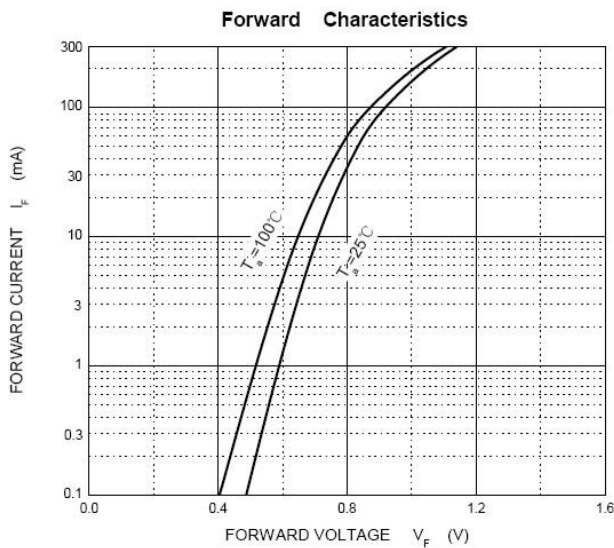



SSCS4148AS6/SSCS4148CAS6 SSCS4148CCS6/SSCS4148SES6

● Package Information

Ordering Information

| Device | Package | Marking | Qty per Reel | Reel Size |
|--------------|---------|---------|--------------|-----------|
| SSCS4148AS6 | SOT-23 | 5H | 3000 | 7 Inch |
| SSCS4148CAS6 | SOT-23 | D6 | 3000 | 7 Inch |
| SSCS4148CCS6 | SOT-23 | D5 | 3000 | 7 Inch |
| SSCS4148SES6 | SOT-23 | D4 | 3000 | 7 Inch |

Mechanical Data

Case: SOT-23

Case Material: Molded Plastic. UL Flammability

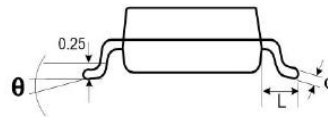
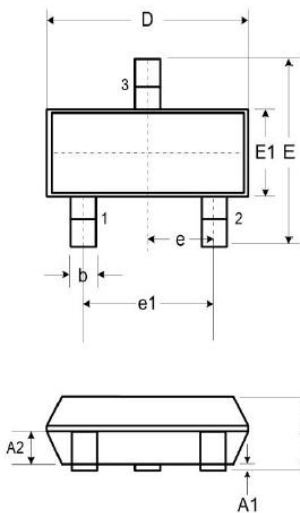

| DIM | Millimeters | | |
|-----|-------------|------|------|
| | Min. | Typ. | Max. |
| A | 0.89 | - | 1.12 |
| A1 | 0.01 | - | 0.10 |
| A2 | 0.88 | 0.95 | 1.02 |
| b | 0.30 | - | 0.51 |
| c | 0.08 | - | 0.18 |
| D | 2.80 | 2.90 | 3.04 |
| E | 2.10 | 2.37 | 2.64 |
| E1 | 1.20 | 1.30 | 1.40 |
| e | 0.95 | | |
| e1 | 1.90 | | |
| L | 0.40 | 0.50 | 0.60 |
| L1 | 0.55 | | |
| N | 3 | | |
| θ | 0° | - | 8° |

Recommended Pad outline (Unit: mm)

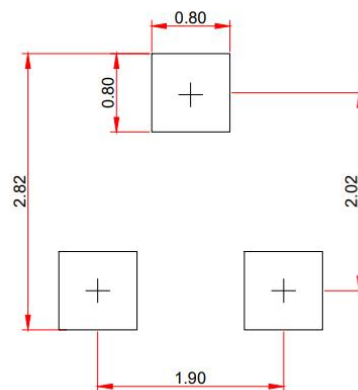



DISCLAIMER

SSCSEMI RESERVES THE RIGHT TO MAKE CHANGES WITHOUT FURTHER NOTICE TO ANY PRODUCTS HEREIN TO IMPROVE RELIABILITY, FUNCTION OR DESIGN. SSCSEMI DOES NOT ASSUME ANY LIABILITY ARISING OUT OF THE APPLICATION OR USE OF ANY PRODUCT OR CIRCUIT DESCRIBED HEREIN; NEITHER DOES IT CONVEY ANY LICIENCE UNDER ITS PATENT RIGHTS, NOR THE RIGHTS OF OTHERS.

THE GRAPHS PROVIDED IN THIS DOCUMENT ARE STATISTICAL SUMMARIES BASED ON A LIMITED NUMBER OF SAMPLES AND ARE PROVIDED FOR INFORMATIONAL PURPOSE ONLY. THE PERFORMANCE CHARACTERISTICS LISTED IN THEM ARE NOT TESTED OR GUARANTEED. IN SOME GRAPHS, THE DATA PRESENTED MAY BE OUTSIDE THE SPECIFIED OPERATING RANGE (E.G. OUTSIDE SPECIFIED POWER SUPPLY RANGE) AND THEREFORE OUTSIDE THE WARRANTED RANGE.

OUR PRODUCT SPECIFICATIONS ARE ONLY VALID IF OBTAINED THROUGH THE COMPANY'S OFFICIAL WEBSITE, CRM SYSTEM, OR OUR SALES PERSONNEL CHANNELS. IF CHANGES OR SPECIAL VERSIONS ARE INVOLVED, THEY MUST BE STAMPED WITH A QUALITY SEAL AND MARKED WITH A SPECIAL VERSION NUMBER TO BE VALID.