



SSCN2222AGSG

High Frequency High Gain NPN Power BJT

➤ Features

VCB	VCE	VEB	IC
75V	40V	6V	600mA

➤ Description

This product is general usage and suitable for many different applications. It can be used for medium power amplifiers and switches requiring collector currents up to 600 mA.

➤ Applications

- Low current and high precision circuits such preamplifiers, oscillators, current mirror configuration
- Medium power amplification and switching

➤ Ordering Information

Device	Package	Shipping
SSCN2222AGSG	SOT-363	3000/Reel

➤ Pin configuration



SOT-363

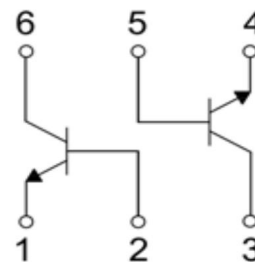

Circuit Diagram

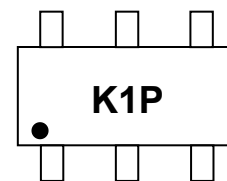

Marking(Top View)



➤ **Absolute Maximum Ratings**($T_A=25^{\circ}\text{C}$ unless otherwise noted)

Parameter	Symbol	Value	Unit
Collector-Base Voltage	V_{CB0}	75	V
Collector- Emitter Voltage	V_{CEO}	40	V
Emitter-Base Voltage	V_{EBO}	6	V
Collector Current-Continuous	I_C	600	mA
Collector Power Dissipation	P_C	200	mW
Junction Temperature	T_J	150	$^{\circ}\text{C}$
Storage Temperature	T_{STG}	-55 to 150	$^{\circ}\text{C}$

➤ **Electrical Characteristics** ($T_A=25^{\circ}\text{C}$ unless otherwise noted)

Parameter	Symbol	Test Conditions	Min.	Typ.	Max.	Unit
Collector-Base Breakdown Voltage	BV_{CB0}	$I_C=0.1\text{mA}, I_E=0$	75			V
Collector-emitter Breakdown Voltage	BV_{CEO}	$I_C=1\text{mA}, I_B=0$	40			V
Emitter -Base Breakdown Voltage	BV_{EBO}	$I_E=0.1\text{mA}, I_C=0$	6			V
Collector Cutoff Current	I_{CB0}	$V_{CB}=60\text{V}, I_E=0$			0.01	μA
Collector Cutoff Current	I_{CEX}	$V_{CE}=60\text{V}, V_{BE}=3\text{V}$			0.01	μA
Emitter Cutoff Current	I_{EBO}	$V_{EB}=3\text{V}, I_C=0$			0.01	μA
DC Current Gain	h_{FE1}	$V_{CE}=10\text{V}, I_C=150\text{mA}$	100		300	
	h_{FE2}	$V_{CE}=10\text{V}, I_C=0.1\text{mA}$	35			
	h_{FE3}	$V_{CE}=10\text{V}, I_C=1\text{mA}$	50			
	h_{FE4}	$V_{CE}=10\text{V}, I_C=10\text{mA}$	75			
	h_{FE5}	$V_{CE}=10\text{V}, I_C=500\text{mA}$	40			
	h_{FE6}	$V_{CE}=1\text{V}, I_C=150\text{mA}$	35			
Collector-Emitter Saturation Voltage	$V_{CE(sat)1}$	$I_C=500\text{mA}, I_B=50\text{mA}$			1.0	V
	$V_{CE(sat)2}$	$I_C=500\text{mA}, I_B=15\text{mA}$			0.3	V
Base-Emitter Saturation Voltage	$V_{BE(sat)1}$	$I_C=500\text{mA}, I_B=50\text{mA}$			2.0	V
	$V_{BE(sat)2}$	$I_C=500\text{mA}, I_B=15\text{mA}$			1.2	V
Transition frequency	fT	$V_{CE}=20\text{V}, I_C=20\text{mA}$ $f=100\text{MHz}$	300			MHz
Output Capacitance	Cob	$V_{CB}=10\text{V}, I_E=0,$ $f=1\text{MHz}$			8	pF
Input Capacitance	Cib	$V_{EB}=0.5\text{V}, I_C=0,$ $f=1\text{MHz}$			25	pF
Noise Figure	NF	$V_{CE}=10\text{V}, I_C=100\mu\text{A},$ $f=1\text{KHz}, R_s=1\text{K}\Omega$			4	dB
Delay Time	td	$V_{CC}=30\text{V}, I_C=150\text{mA},$			10	ns
Rise Time	tr	$I_{B1}=15\text{mA}$			25	ns
Storage Time	ts	$V_{CC}=30\text{V}, I_C=150\text{mA},$			225	ns
Fall Time	tf	$I_{B1}= I_{B2}=15\text{mA}$			60	ns



Typical Performance Characteristics (TA=25°C unless otherwise noted)

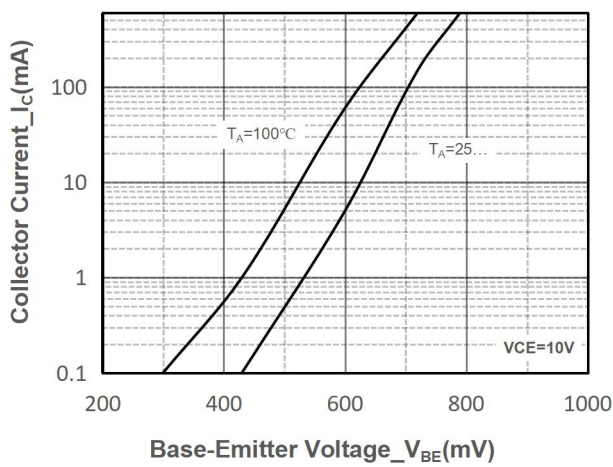

Collector Current vs. Base-Emitter Voltage

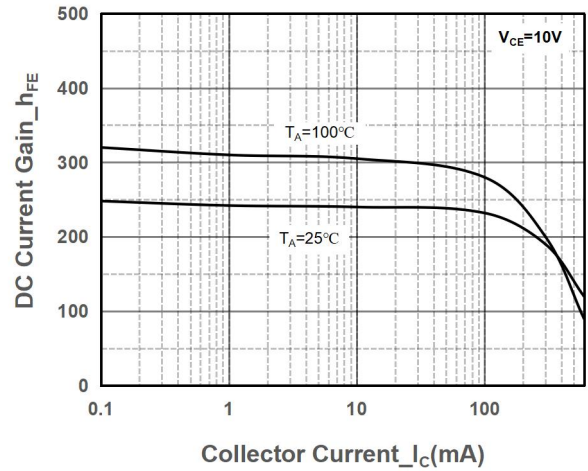

DC Current Gain vs. Collector Current

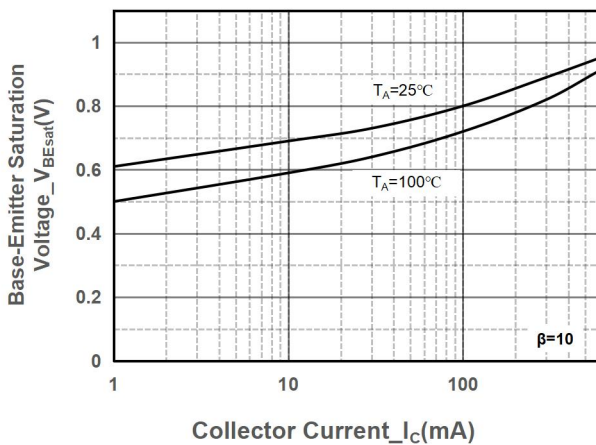

$V_{BE(sat)}$ vs. Collector Current

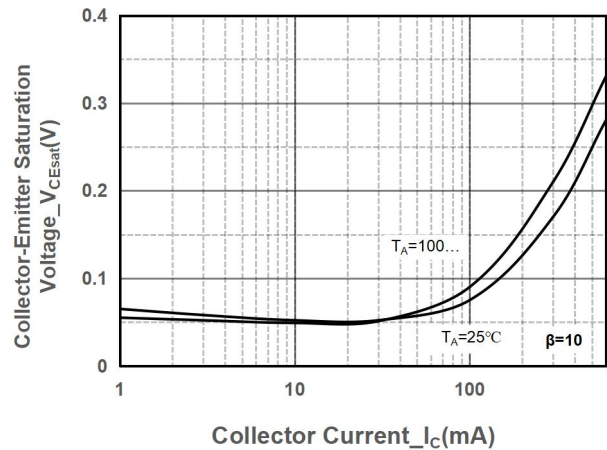

$V_{CE(sat)}$ vs. Collector Current

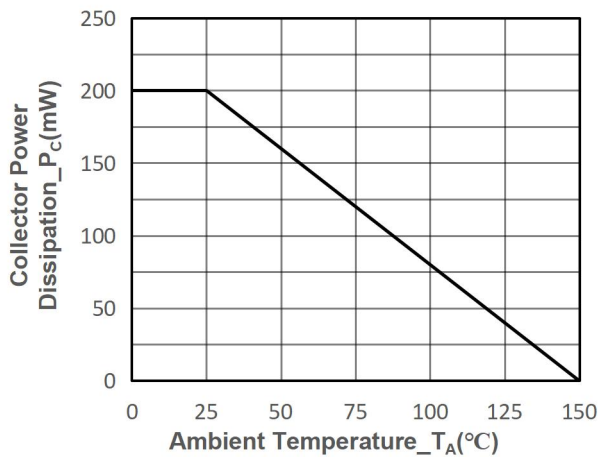

Power derating vs. Ambient temperature

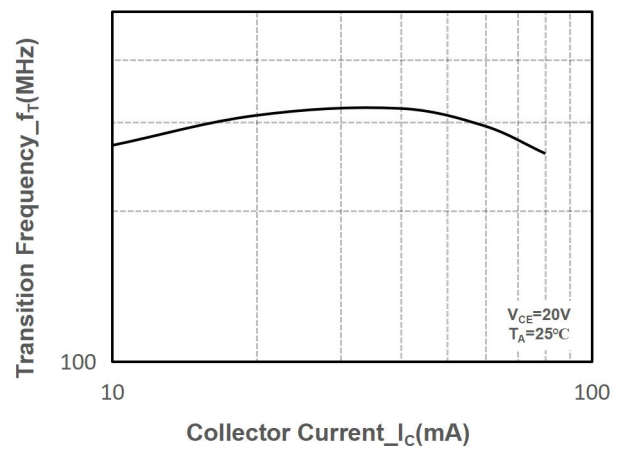

Transition Frequency vs. Collector Current

➤ Package Information

SOT-363

TOP VIEW

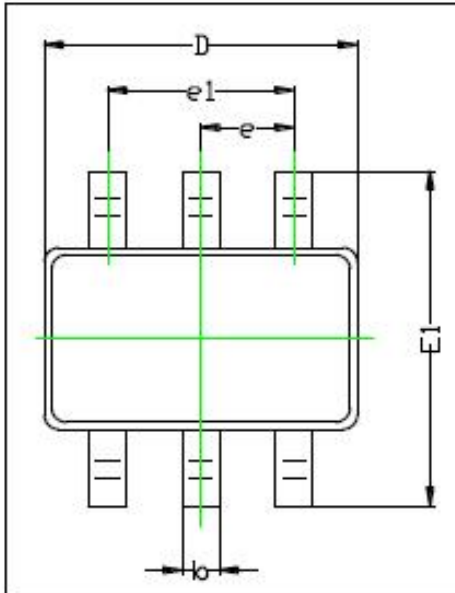

SIDE VIEW

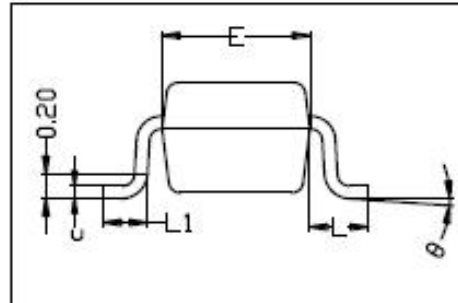

SOLDING PATTERN

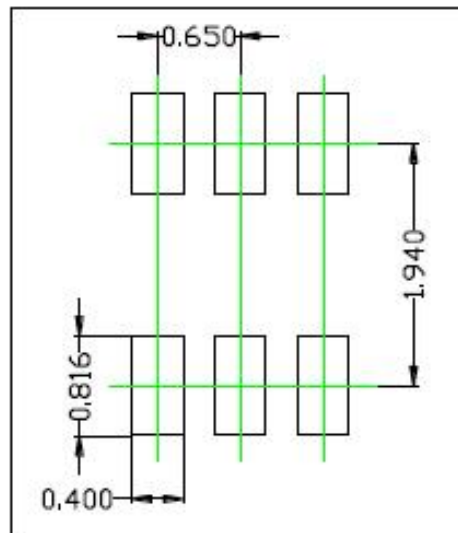

FRONT VIEW

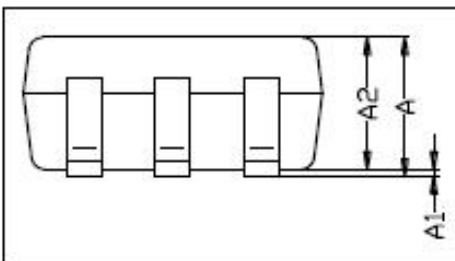

SYMBOL	DIMENSIONS IN MILLIMETER	
	MIN	MAX
A	0.900	1.000
A1	0.000	0.100
A2	0.900	1.000
b	0.150	0.300
c	0.100	0.150
D	2.000	2.200
E	1.150	1.350
E1	2.150	2.400
e	0.650 TYP.	
e1	1.200	1.400
L	0.525 REF.	
L1	0.260	0.450
θ	0°	8°



DISCLAIMER

SSCSEMI RESERVES THE RIGHT TO MAKE CHANGES WITHOUT FURTHER NOTICE TO ANY PRODUCTS HEREIN TO IMPROVE RELIABILITY, FUNCTION OR DESIGN. SSCSEMI DOES NOT ASSUME ANY LIABILITY ARISING OUT OF THE APPLICATION OR USE OF ANY PRODUCT OR CIRCUIT DESCRIBED HEREIN; NEITHER DOES IT CONVEY ANY LICIENCE UNDER ITS PATENT RIGHTS, NOR THE RIGHTS OF OTHERS.

THE GRAPHS PROVIDED IN THIS DOCUMENT ARE STATISTICAL SUMMARIES BASED ON A LIMITED NUMBER OF SAMPLES AND ARE PROVIDED FOR INFORMATIONAL PURPOSE ONLY. THE PERFORMANCE CHARACTERISTICS LISTED IN THEM ARE NOT TESTED OR GUARANTEED. IN SOME GRAPHS, THE DATA PRESENTED MAY BE OUTSIDE THE SPECIFIED OPERATING RANGE (E.G., OUTSIDE SPECIFIED POWER SUPPLY RANGE) AND THEREFORE OUTSIDE THE WARRANTED RANGE.

OUR PRODUCT SPECIFICATIONS ARE ONLY VALID IF OBTAINED THROUGH THE COMPANY'S OFFICIAL WEBSITE, CRM SYSTEM, OR OUR SALES PERSONNEL CHANNELS. IF CHANGES OR SPECIAL VERSIONS ARE INVOLVED, THEY MUST BE STAMPED WITH A QUALITY SEAL AND MARKED WITH A SPECIAL VERSION NUMBER TO BE VALID.