



SSCS4148SG

Switching Diode

● Features

- ✧ Fast Switching Device ($T_{rr} < 4\text{ns}$)
- ✧ Power Dissipation of 200mW
- ✧ Low reverse leakage
- ✧ High Stability and High Reliability
- ✧ RoHS Compliant

● PIN configuration

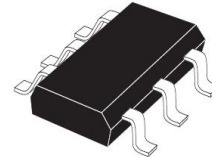

SOT-363

● Applications

- ✧ Ultra high-speed switching
- ✧ Voltage clamping
- ✧ Protection circuits
- ✧ Blocking diodes

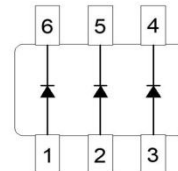

Circuit Diagram



Marking(Top View)

● Absolute maximum rating @ $T_A=25^\circ\text{C}$

Parameter	Symbol	Value	Unit
Peak Reverse Voltage	V_{RM}	100	V
Continuous Reverse Voltage	V_R	75	V
Average Rectified Output Current	I_O	150	mA
Repetitive Peak Forward Current	I_{FM}	300	mA
Non-repetitive Peak Forward Surge Current @ $t=8.3\text{ms}$	I_{FSM}	2	A
Power Dissipation	P_D	200	mW
Thermal Resistance from Junction to Ambient	$R_{\theta JA}$	625	$^\circ\text{C/W}$
Junction Temperature	T_J	-55 ~ +150	$^\circ\text{C}$
Storage Temperature	T_{STG}	-55 ~ +150	$^\circ\text{C}$



● Electrical Characteristics @T_A=25°C

Parameter	Symbol	Conditions	Min.	Typ.	Max.	Unit
Reverse Breakdown Voltage	V _{BR}	I _R = 100μA	100			V
		I _R = 5μA	75			V
Forward Voltage	V _F	I _F = 1mA			0.715	V
		I _F = 10mA			0.855	V
		I _F = 50mA			1	V
		I _F = 150mA			1.25	V
Reverse Current	I _R	V _R = 20V			25	nA
		V _R = 75V			1	μA
Junction Capacitance	C _J	V _R = 0V, f = 1MHz			2	pF
Reverse recovery time	t _{rr}	I _F =I _R =10mA, R _L =100Ω, I _{rr} =0.1I _R			4	ns

● Typical Performance Characteristics

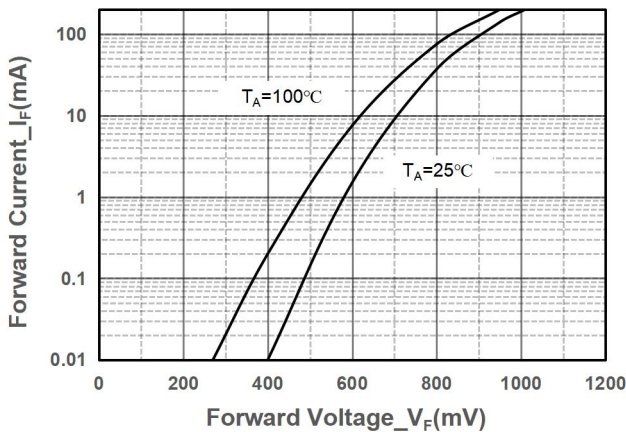

Forward Current vs. Forward Voltage

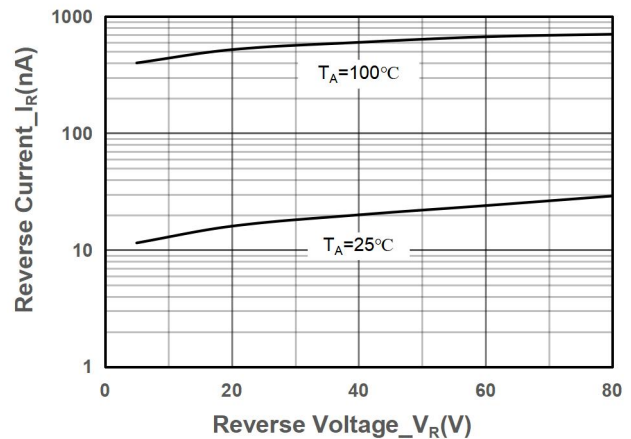

Reverse Current vs. Reverse Voltage

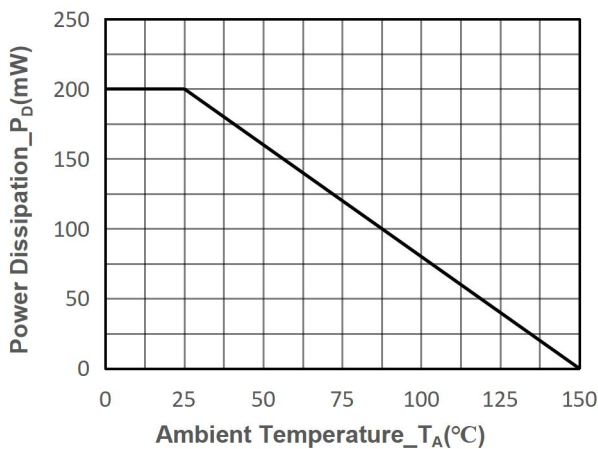

Power Derating vs. Ambient Temperature

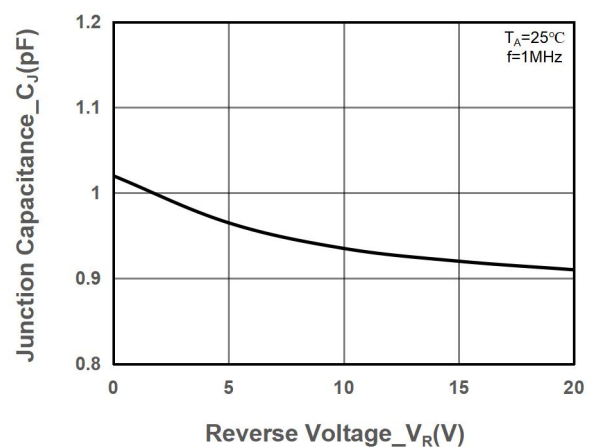

Junction Capacitance vs. Reverse Voltage



● Package Information

Ordering Information

Device	Package	Marking	Qty per Reel	Reel Size
SSCS4148SG	SOT-363	N10	3000	7 Inch

Mechanical Data

Case: SOT-363

Case Material: Molded Plastic. UL Flammability

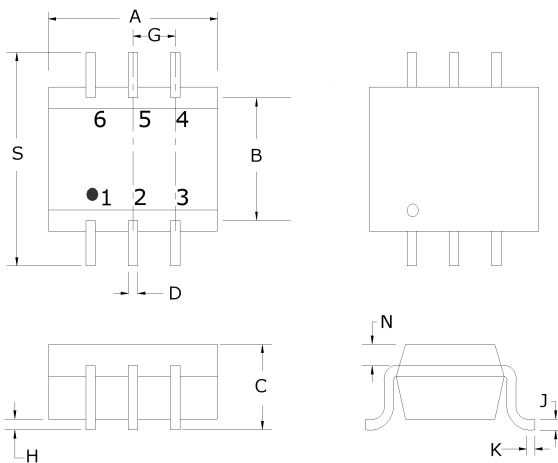

DIM	Millimeters		
	Min	Nom	Max
A	1.90	2.00	2.20
B	1.15	-	1.35
C	0.90	-	1.10
D	0.15	-	0.35
G	0.65BSC		
H	-	-	0.10
J	0.08	-	0.15
K	0.15	-	0.35
S	2.10	-	2.45
N	0.20REF		

Recommended Pad outline

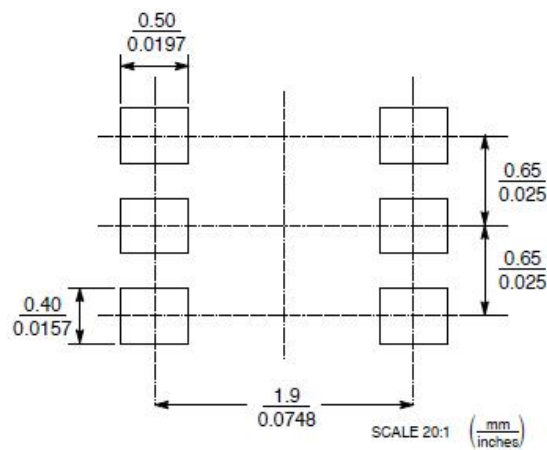



DISCLAIMER

SSCSEMI RESERVES THE RIGHT TO MAKE CHANGES WITHOUT FURTHER NOTICE TO ANY PRODUCTS HEREIN TO IMPROVE RELIABILITY, FUNCTION OR DESIGN. SSCSEMI DOES NOT ASSUME ANY LIABILITY ARISING OUT OF THE APPLICATION OR USE OF ANY PRODUCT OR CIRCUIT DESCRIBED HEREIN; NEITHER DOES IT CONVEY ANY LICIENCE UNDER ITS PATENT RIGHTS, NOR THE RIGHTS OF OTHERS.

THE GRAPHS PROVIDED IN THIS DOCUMENT ARE STATISTICAL SUMMARIES BASED ON A LIMITED NUMBER OF SAMPLES AND ARE PROVIDED FOR INFORMATIONAL PURPOSE ONLY. THE PERFORMANCE CHARACTERISTICS LISTED IN THEM ARE NOT TESTED OR GUARANTEED. IN SOME GRAPHS, THE DATA PRESENTED MAY BE OUTSIDE THE SPECIFIED OPERATING RANGE (E.G., OUTSIDE SPECIFIED POWER SUPPLY RANGE) AND THEREFORE OUTSIDE THE WARRANTED RANGE.

OUR PRODUCT SPECIFICATIONS ARE ONLY VALID IF OBTAINED THROUGH THE COMPANY'S OFFICIAL WEBSITE, CRM SYSTEM, OR OUR SALES PERSONNEL CHANNELS. IF CHANGES OR SPECIAL VERSIONS ARE INVOLVED, THEY MUST BE STAMPED WITH A QUALITY SEAL AND MARKED WITH A SPECIAL VERSION NUMBER TO BE VALID.